



Actuating change

Comfortable

Rounded



GA Model

FUEL DISPENSER

Absolutely Brilliant.

GA Model

A brand-new season for fuel stations has come. Tokico System Solutions launches the advanced all-round fuel dispensers to the world. Various choices of models with user-friendly design will match with every station layout. The excellent appearance and state-of-the-art technology are ready to enhance your brilliant future.

GAT2 Low Type



GA26 High Type



ALL MADE IN JAPAN.

Contents

Features ————— P04

GA Model Lineup — P06

Bright and Clear Display

High-contrast Black Display

We apply a brand-new LCD panel for the new model with high-contrast, high-luminance and large characters.

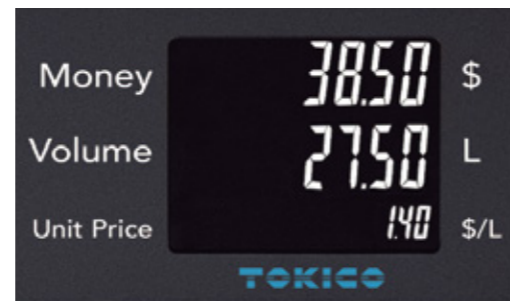

Indication Example

User Friendly Preset Function

Preset Functional Buttons

8 preset buttons which any volume and any money can be registered in.

Light and Sound

Smart operation is realized with light and sound when pressing preset keypad.

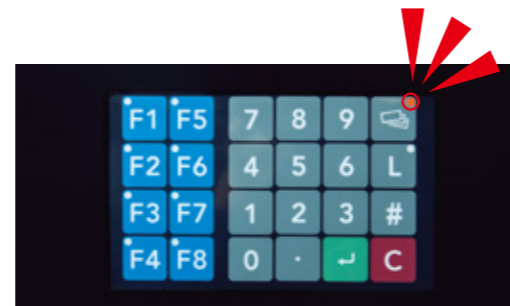

High Accuracy

Super-precise Flowmeter by Tokico System Solutions

Precise measurement $\pm 0.25\%$ is realized with Japan-made flowmeter developed in our factory.

Electromagnetic Sensor

Non-contact magnetic-resistance sensor originally-developed in Japan is adopted for stable measurement and longer life.

High Performance in Repeated Small-Amount Fueling

Accuracy is always stable by special software program designed for repeated small-amount fueling to motorbikes.



1-pump and 2-flowmeter Unit

Safety Functions

Impact Detection

Fueling is instantly stopped when the car accident or earthquake occurs.

Power Surge Protection

The protection board, which is easy to replace, secures the electronic components in a sudden power surge.

Over Time / Over Volume Detection

Fueling is automatically stopped if the dispenser detects over time / over volume fueling.

Emergency Stop Switch

In case of the emergency, fueling can be manually stopped as well.

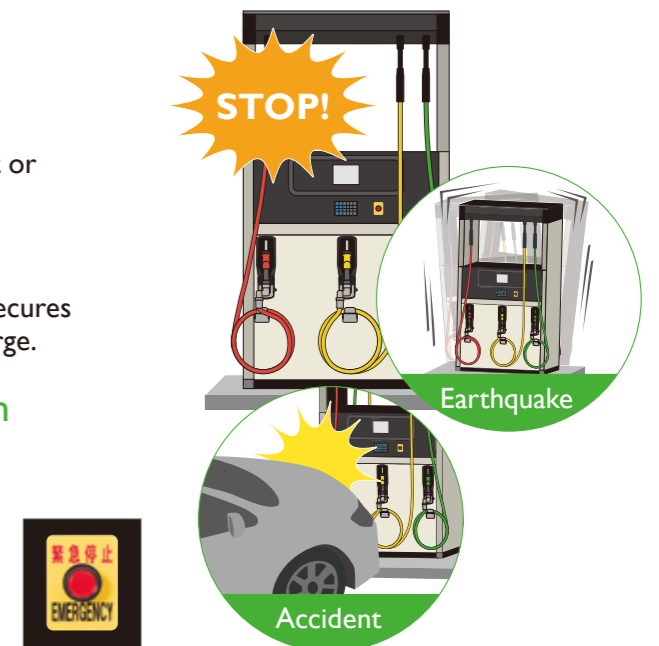

Easy Maintenance

Unique Design

Simple structure for maintenance is realized because the pump and the flowmeter are directly connected.

Dual Filters in Pump

Both filters in the pump can be easily removed and cleaned up.

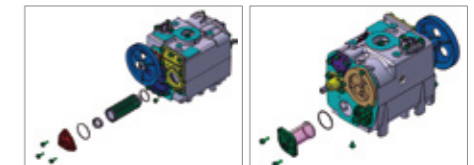

Dual-filter Structure

Error Messages

Easy-to-understand error messages show the current status of dispenser.



Easy Daily Check

Unnecessary to remove the main body panel for periodical inspection.



Long Life Design

Rust-Proof Body

High-corrosion galvanized steel plate makes the dispenser body stronger.



Results of Salt Spray Long-life Test Based on Japanese Standard

GA Model Lineup

		Super Wide Body W=1586mm		Wide Body W=1246mm					Narrow Body W=880mm					High Capacity Model W=880mm				
		GA48	GA28	GA48	GA28	GA66	GA26	GA24	GAF4	GAT4	GAD4	GAT2	GA22	GAD2	GA11	High Capacity GAV2	Ultra High Capacity GAU2	
Dimensions (H×W×D mm)	High	2300×1586×510		2300×1246×510					2300×880×510					2300×880×510				
	Low	—		—					1440×880×510					1440×880×510				
Inner Structure																		
Suction Type		●	●	—	—	●	●	●	●	●	●	●	●	●	●	—	●	
Submersible Type		—	—	●	●	—	●	●	●	●	●	●	—	—	●	●		
Products		4	4	4	4	3	3	2	2	2	2	2	1	1	2	1		
Simultaneous Fueling		4	2	4	2	6	2	2	4	2	4	2	2	2	1	2	2	
Pump / Inlet		4	4	4	4	3	3	2	2	2	2	2	2	1	1	2	2	
Flowmeter		8	8	8	8	6	6	4	4	4	4	2	2	2	1	4	2	
Hose&Nozzle		8	8	8	8	6	6	4	4	4	4	2	2	2	1	2	2	
Emergency Stop Switch		2	2	2	2	2	2	2	2	2	2	2	2	2	2	2	2	
Preset Keypad		4	2	4	2	6	2	2	4	2	4	2	4	2	2	2	4	
Display		4	2	4	2	6	2	2	4	2	4	2	4	2	2	2	4	
Nozzle Position		Front		Front					Front					Side	Front	Side	Front	Side

*All pictures are for illustrative purposes only.

Specification

Model		Suction Type	Submersible Type
Delivery Speed*	Standard Capacity	40L/min (Simultaneous Fueling:40L/min)	40L/min (Simultaneous Fueling:40L/min)
	High Capacity	GA11,GAT2,GA22:70L/min (Simultaneous Fueling:70L/min)	GAT2,GA22:70L/min (Simultaneous Fueling:70L/min)
		Other Models:70L/min (Simultaneous Fueling:40L/min)	Other Models:70L/min (Simultaneous Fueling:40L/min)
	Ultra High Capacity	GAU2 : 180L/min (Simultaneous Fueling: 90L/min & 55L/min)	GAU2 : 180L/min (Simultaneous Fueling: 90L/min & 55L/min)
—		GAV2:150L/min (Simultaneous Fueling:150L/min)	
Flowmeter	Type	4-piston positive displacement flowmeter	
	Accuracy	±0.25%	
Display	Type	LCD with LED backlight	
	Money	7 digits	
	Volume	7 digits	
	Unit Price	5 digits	
	Power Failure	Transaction data is maintained for 15 minutes	
Preset Keypad	10-key Part	Both for volume and money preset	
	One-touch Key Part	8 different values	
Power Source		Depending on the local power source	
Operating Conditions	Temperature	+5°C to 40°C	
	Relative Humidity	+5% to 95%	

*Delivery speed may differ according to piping condition, hoses, nozzles and submersible pump capacity.

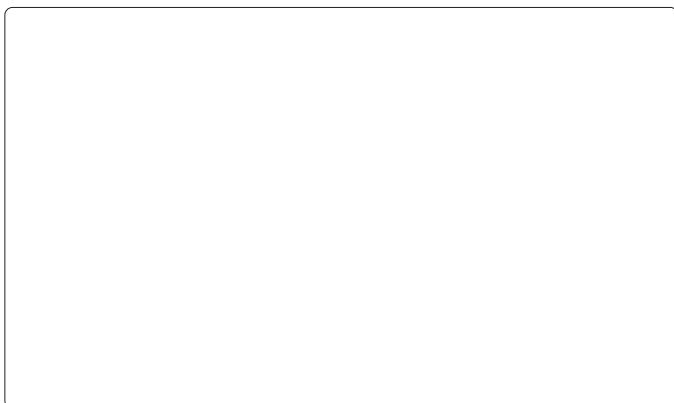

Specifications are subject to change without prior notice.

Tokico System Solutions, Ltd.

Global Business Div.

Parale Mitsui Building, 8, Higashida-cho,
Kawasaki-ku, Kawasaki-shi, Kanagawa 210-0005 Japan
TEL. +81-50-3852-5336 FAX. +81-44-222-7155

<https://www.tokicosys.com/en/>

